

# Keloray



## User Manual AE200

[www.kelolight.com](http://www.kelolight.com)

---

# Get Started

Thank you for choosing Keloray AE200 series as your LED lighting system.

## SAFETY INSTRUCTIONS

- Never look directly at the LEDs, because light emits from LEDs may cause eyes or skin injuries. UV emits from this product can cause permanent damage to the eyes or skin. Please minimize exposure of your eyes and skin directly to LEDs.
- A drip loop must be used with all electrical aquarium devices. A drip loop is self-made by installing part of the power cord looping down below the power socket.
- Keloray is not responsible for problems, your personal safety or equipment damage caused by your mishandling of the product.
- Check the power cord, plug and socket are intact.
- Before installing, please read all state and local laws, make sure you use a compliant power adapter.
- Ask a qualified person for the wiring installation.
- Fix the light fixture reliably and steadily.
- Do not put anything on the product.
- Avoid objects entering the unit. Keep the slot and ventilation's openings clean, they should not be blocked or covered.
- Do not allow water to splash, or place unit in the water.
- If the light fixture or power supply becomes damaged, please have it repaired or replaced by a professional person.

# INSIDE THE BOX

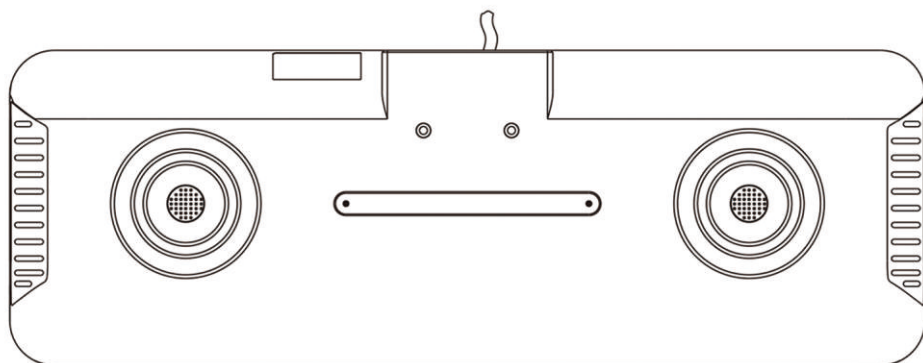

AE200 X 1

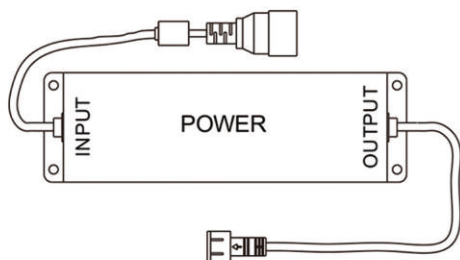

Power Adapter X 1



Power Cord X 1

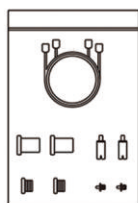

Pendant Cord X1



User Manual X 1

# NAVIGATION

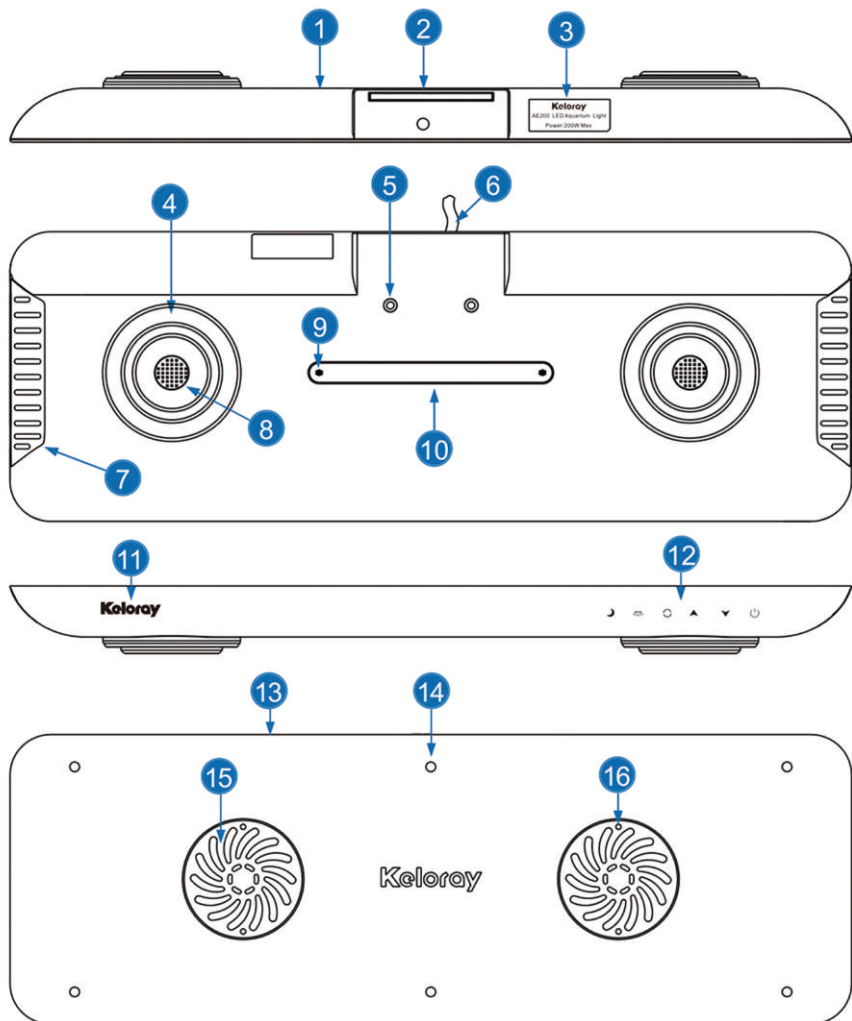



- |                      |                  |                   |                            |
|----------------------|------------------|-------------------|----------------------------|
| 1 Plastic Shell      | 2 Mounting Guide | 3 Label           | 4 Angel Eyes Moon Light    |
| 5 Mounting Fix Screw | 6 Power Cord     | 7 Vent            | 8 LED Array                |
| 9 WiFi Indicator     | 10 Fill Light    | 11 Logo           | 12 Touch Sensitive Buttons |
| 13 Top Cover         | 14 Screw         | 15 Fan(Air Inlet) | 16 Mounting Hole           |



⚠ Please keep the light buttons clean and dry,also make sure your fingers dry,otherwise touching keys will fail.

## On/Off Button

Touch the(  ) button to turn on the AE200.Touch the(  ) once more will shut the light off. When turn on AE200, brightness will turn on step by step in order to protect eyes.



## Moon Light Button

Touch the (  ) button to turn on the Angel Eyes moon light.This button has 4 cycle brightness from 1-2-3-0.



## Fill Light Button

Touch the (  ) button to turn on the strip Fill light.This button has 4 cycle brightness from 1-2-3-0.

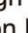

## Color Switch Button

Cycle through programs by using the (  ) button.Default programs can be customized through the App.



## Cycle Color Up Button

This button has 6 cycle brightness steps,brightness from 0-1-2-3-4-5.



## Cycle Color Down Button

This button has 6 cycle brightness steps, brightness from 5-4-3-2-1-0.



## Start Lamp

Connect the AE200 to the power adapter and plug it into a wall outlet.

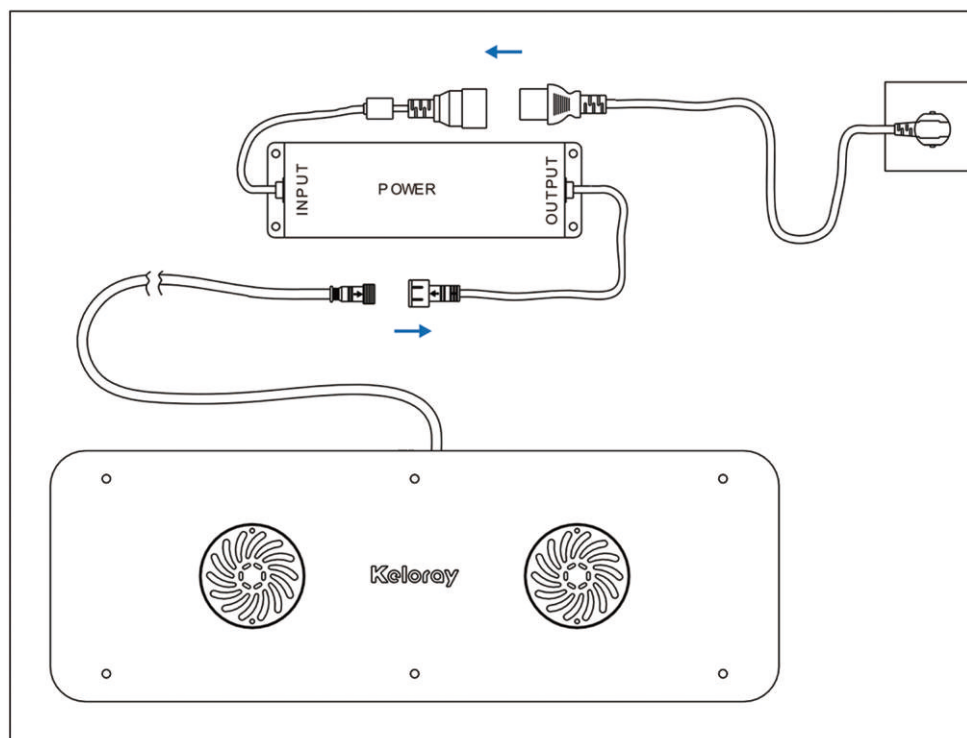

## 2. Mounting the bracket

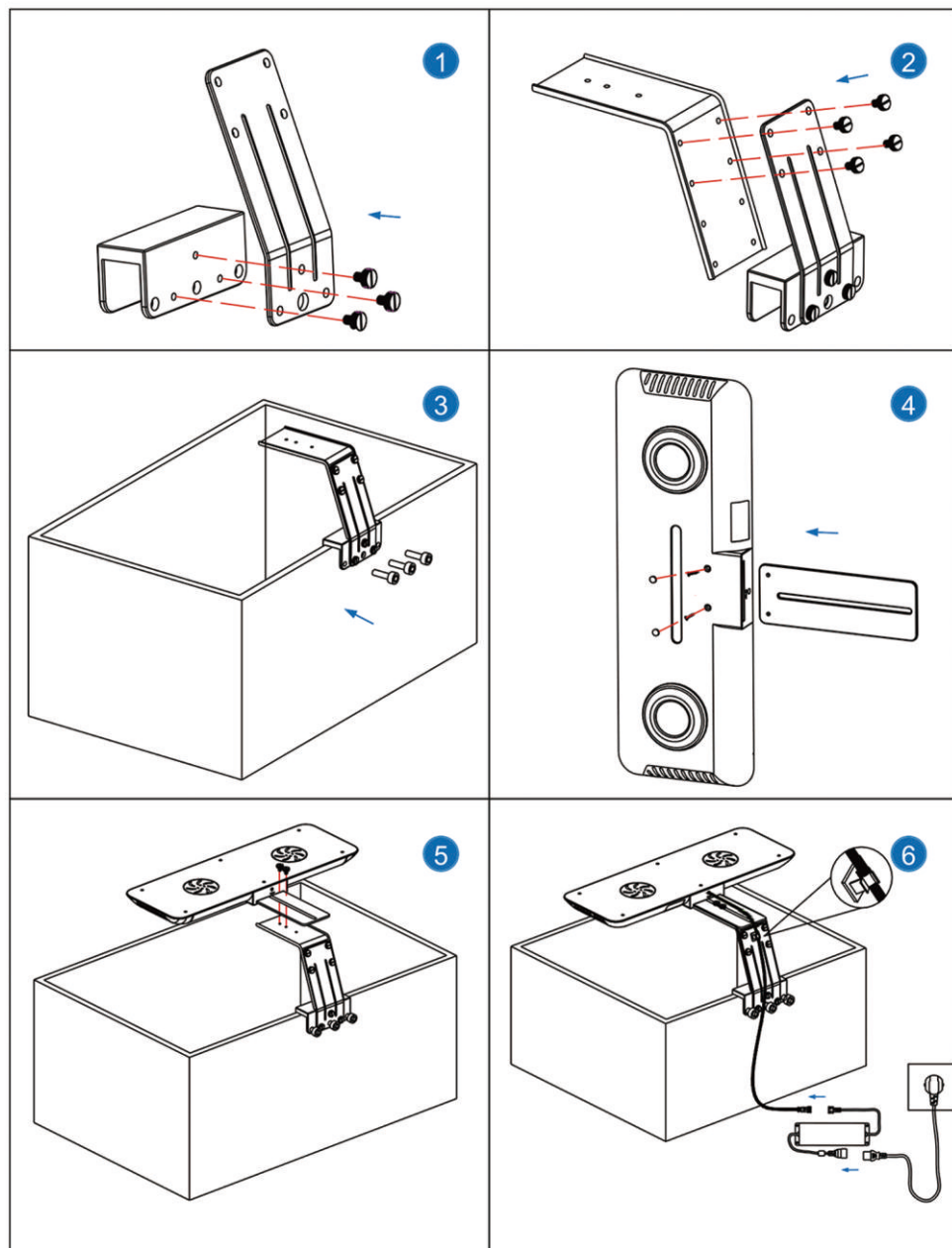

## 2. Mounting the bracket

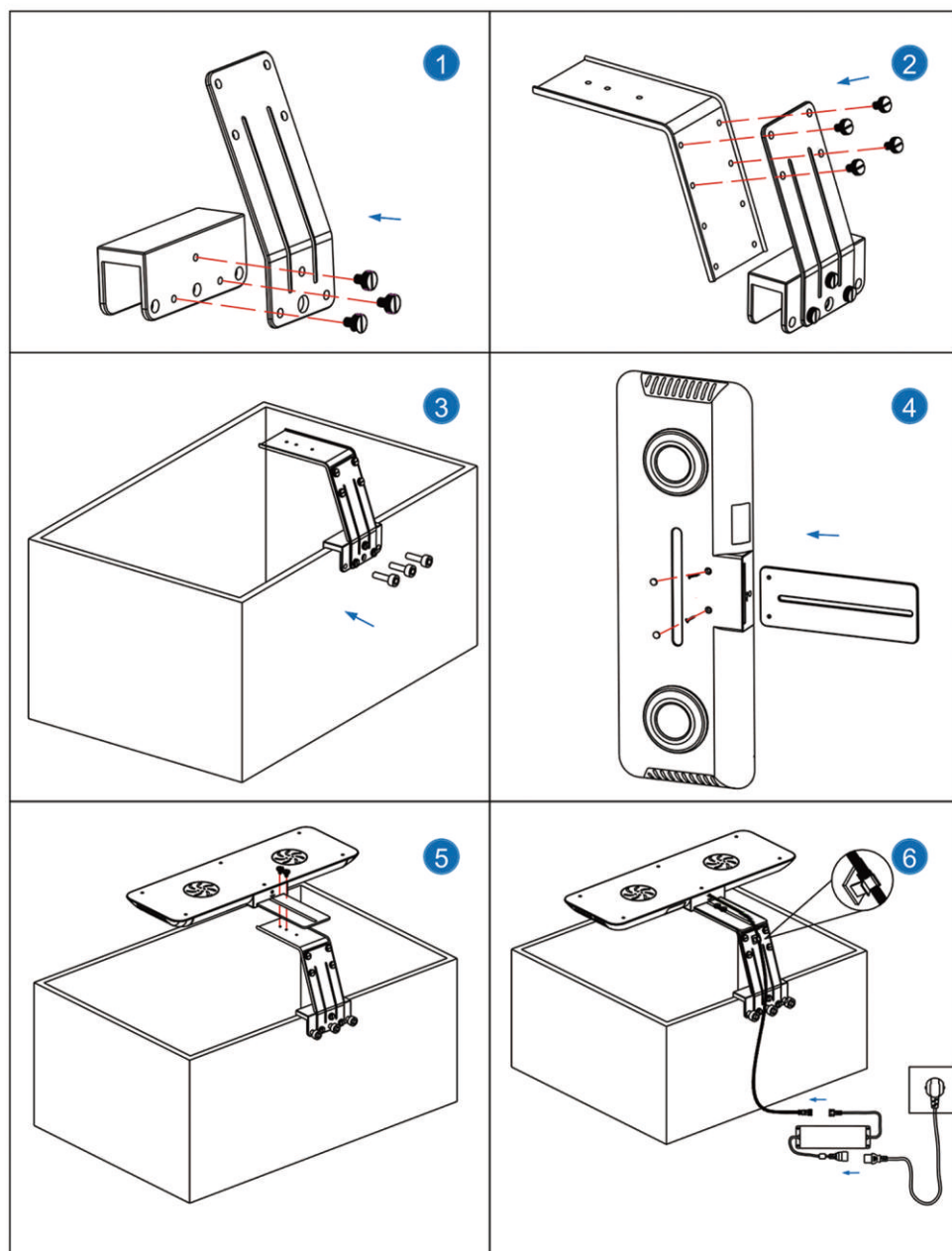

# PRODUCT SPECIFICATIONS

Dimensions and Weight	
Light Size	L 520*W180*H33mm
Package Size	L 580*W345*H75mm
Net Weight(Lamp Body)	2.6kg
Gross Weight(Lamp+ Accessories)	5.7kg
Power Supply	
Input Voltage	100-240V AC
Output Voltage	24V DC
Power Consumption	200W

## WiFi Controller App User Manual

Keloray WiFi controller have two different connection modes:

### 1.Connect Directly to Light

Press ( ▼ ) and ( ↻ ) simultaneously in 2 to 3 seconds until hear “beep” from the light,release fingers,switch to “Connect Direct to Light mode”.

- a.Factory default connect mode.
- b.Wireless router is not necessary.
- c.Can't use WiFi network or cellular data.
- d.Can't make group lights programming.

## 2. Use Wireless Router

Press ( ▲ ) and ( 🔁 ) simultaneously for 2 to 3 seconds till hear “beeps” from the light, release fingers, switch to “Wireless Router connect mode”.

- a. Phone can connect to internet and control light at the same time.
- b. Both of the mobile phone and aquarium light need join Wireless Router (Household/Store WiFi Network).
- c. One mobile phone device can program a group of lights at the same time.

Indicating lamp	Means
Indicating lamp turn off after keep 3s	Lamp working under “connect directly to light” mode. (When power turn on, the indicator light will be off a few seconds, means WiFi is working under the “connect to light” mode )
Indicating lamp twinkle two times then turn off one time	WiFi working under the network mode, waiting for configuration status. (When WiFi been a network mode, but the lamp is not connected to the router, you need manual setting, connect light to router )
Indicating lamp twinkle three times then turn off one time	WiFi working under network mode, error occurred while connecting to the home router, which may be a password error or router is turned off
Indicating lamp ruleless twinkle	Transmitting data
Indicating lamp extinguishes	No transmitting data
Indicating lamp keep on	Abnormal operation

# Connection

## Download APP

- IOS Operating System 9.3.1 or above is recommended.
- IOS device open "Apple store".Search for and download "Keloray" App.
- Android device open "Google Play".Search for and download "Keloray"App.



## Connect Light Directly

- 1.Make sure the light is connected to wall outlet through power adapter.
- 2.Exit the App and access phone "Setting" WiFi to connect Keloray WiFi SSID (**Default password:12345678**) (Sample picture 1)
- 3.Select Wi-Fi SSID:AE200-XXXX to link. Make sure there is a WiFi signal icon at top right corner.
- 4.Go back to App, press Search icon to find light (Sample picture 2)
- 5.Press "AE200-XXXX 192.168.0.XX" to select light (Sample picture 3)
- 6.Finish above operations,press "Connect" to control the light.



Sample picture 1

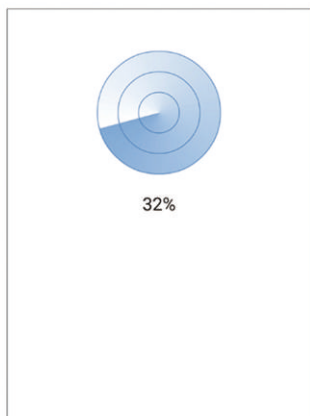

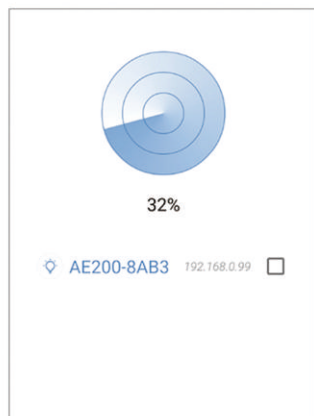

Sample picture 2



Sample picture 3

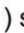

## Connect to Router

1. Make sure the light is connected to wall outlet through power adapter.
2. Access phone "Settings" WiFi. Connect to select Wireless Router (Household/Store). (Make sure there is a WiFi signal icon at top right corner.)
3. Touch the power button (  ) to turn on the light (Sample picture 4).
4. Press (  ) and (  ) simultaneously for 2 to 3 seconds to turn on "Wireless Router connect mode". The Angel Eyes will flash with blue light, light restart (Sample picture 5).



Sample picture 4



Sample picture 5

5. After light restarted, the mini WiFi indicator light start to flash (Sample picture 6).
6. Open "Keloray" App to home page, press "Connect" choose "Connect to Router" (Sample picture 7).

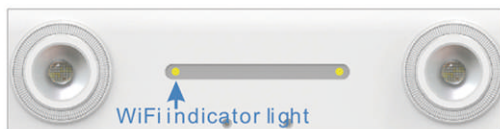

Sample picture 6

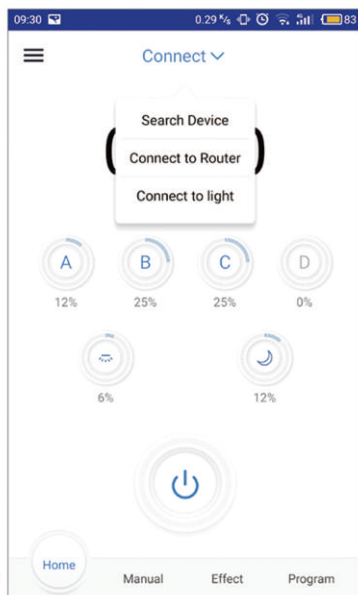

Sample picture 7



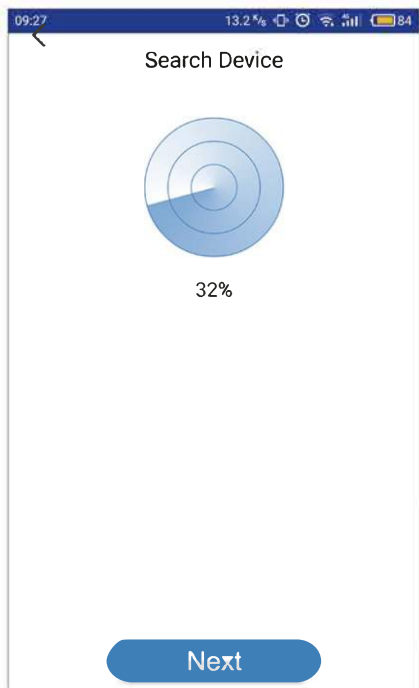

7. Follow the instructions on the APP and then press “Next” to enter (Household /Store )WiFi Network passwords.
8. Press “Start” to connect, when the indicator light stop flashing, it means connect successfully to the router.
9. Go back to APP home page, press search icon to search the light ( sample picture 8).
10. Press “AE200-XXXX 192.168.0.XX” to select light ( Sample picture 9).
11. Finish above operations, press "Next" to join WiFi router.

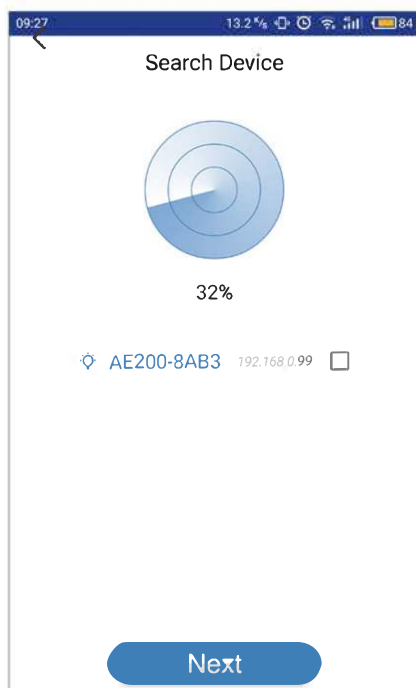

Sample picture 8



Sample picture 9

- ⚠ Remind:** If you want to switch to “Connect to light directly” Mode, please press (  ) and (  ) simultaneously, then repeat above operation. (Sample picture 10)



Sample picture 10

# Controlling&Programming

## Home Page

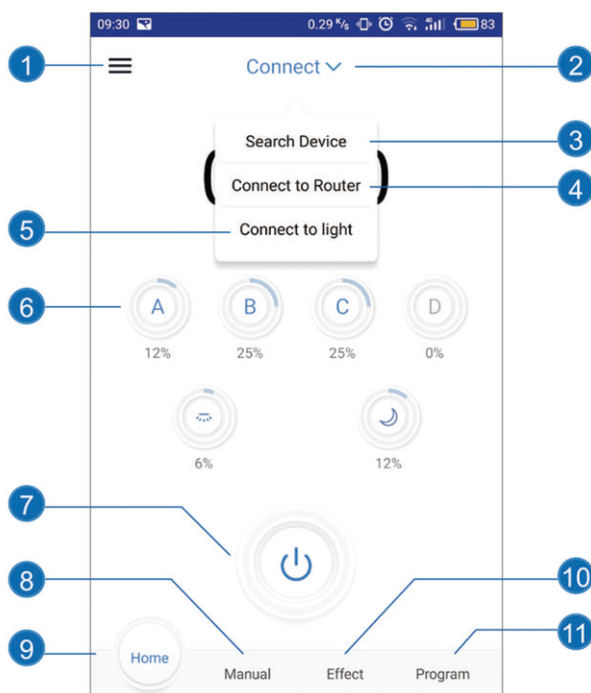

### 1 Menu

Information List: Keloray Logo, Keloray Website, Restore Default, Update Version, User Manual, Ask for Help, Hardware Version, Software Version.

### 2 Connect List

Tap to list connect methods.

### 3 Search Device

Tap to search connected succeeded lights.

### 4 Connect to Router

Tap to "Connect WiFi Router".

### 5 Connect to light

Tap to "Connect light directly".

## 6 Color Channels

Current brightness of each color channels.

## 7 ON/OFF Button

Tap to turn on/turn off light.

## 8 Manual Page Navigation

Tap to Manual program page.

## 9 Home Page Navigation

Tap to Home page.

## 10 Effect Page Navigation

Tap to Effect Show page.

## 11 Program Page Navigation

Tap to Program page.

# Manual Page

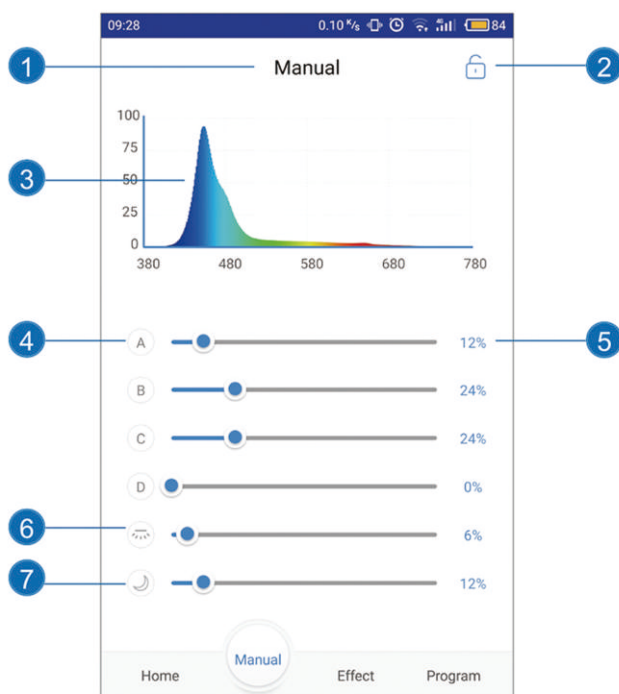

### 1 Manual Page

Manual program can change light intensity only, can't set time point to make intensity change automatically.

### 3 Spectrogram

Current spectrogram of the light.

### 5 Intensity Percentage

Slide the bar, percentage will change between 0%-100%.

### 7 Moon Light

Slide the bar to change intensity of Angel Eyes moon light.

### 2 Lock/Unlock Button

Switch to stay on the manual mode.

Remind: when lock the manual mode, the light will work at the manual intensity. Please don't lock the manual mode if not necessary.

### 4 Color Bar

Slide the bar to change intensity of each color.

### 6 Fill Light

Slide the bar to change intensity of Fill light.

## Effect Page

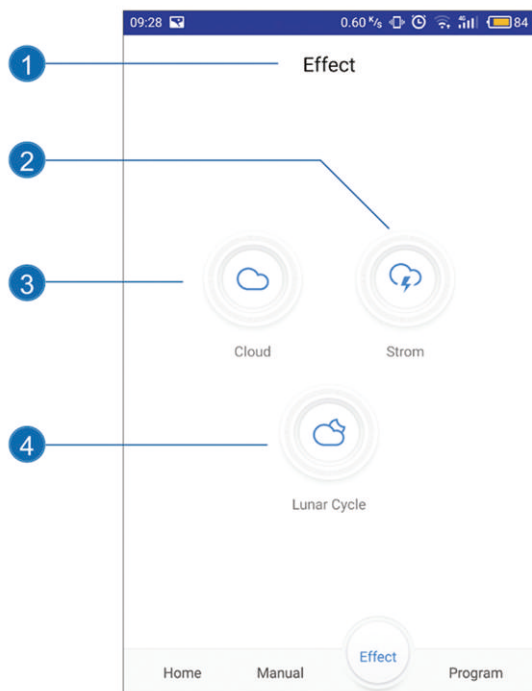

### 1 Effect Options

An effect quick show page for functions: Cloud, Strom and Lunar Cycle. Just for quick show, your program can't be saved on this page.

### 2 Strom Button

Tap to Strom setting.

### 3 Cloud Button

Tap to Cloud setting.

### 4 Lunar Cycle Button

Tap to Lunar Cycle setting.

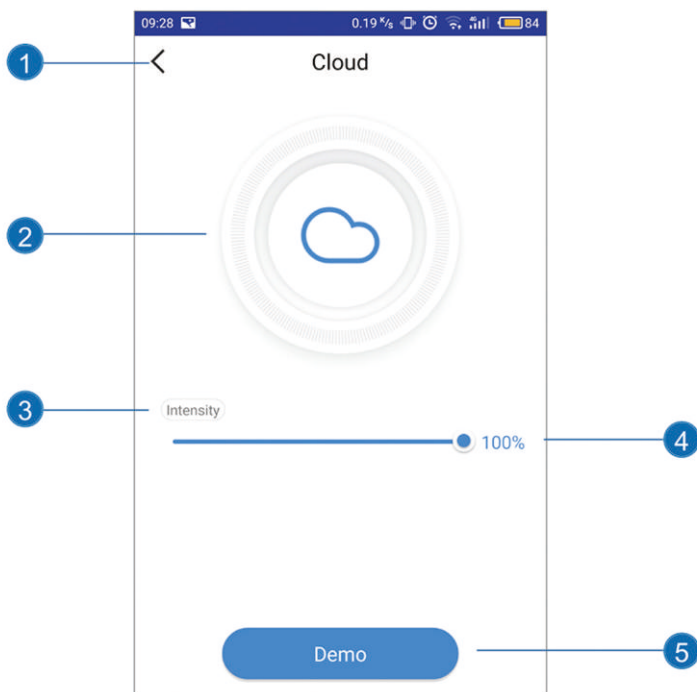

**1 Back Button**

Go back to previous page.

**2 Cloud Icon**

Simulated sunlight at cloudy weather.

**3 Set Intensity**

Slide the bar to slightly adjust the intensity of cloud.

**4 Intensity Percentage**

Slide the bar, percentage will change between 0%-100%.

**5 Demo Button**

Tap to preview Cloud effect. Tap again to stop.

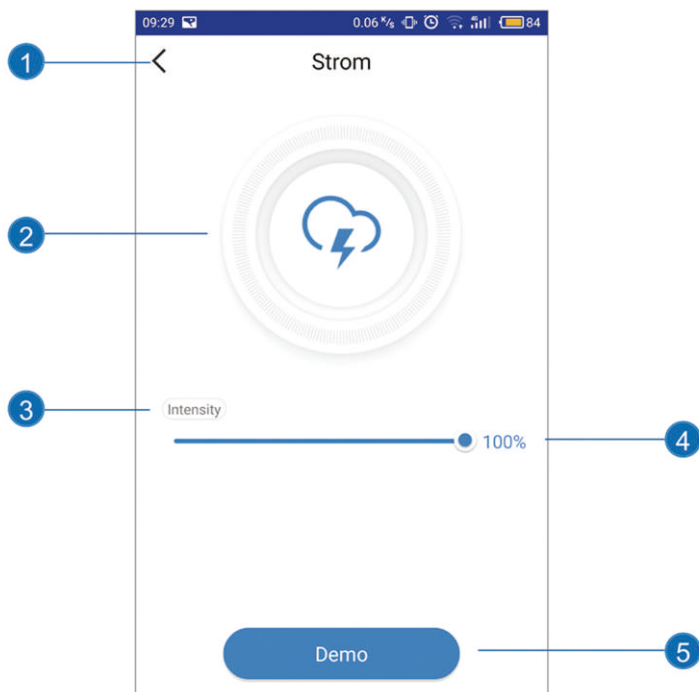

**1 Back Button**

Go back to previous page.

**2 Storm Icon**

Simulated sunlight at stormy weather.

**3 Set Intensity**

Slide the bar to slightly adjust the intensity of storm.

**4 Intensity Percentage**

Slide the bar, percentage will change between 0%-100%.

**5 Demo Button**

Tap to preview Storm effect. Tap again to stop.

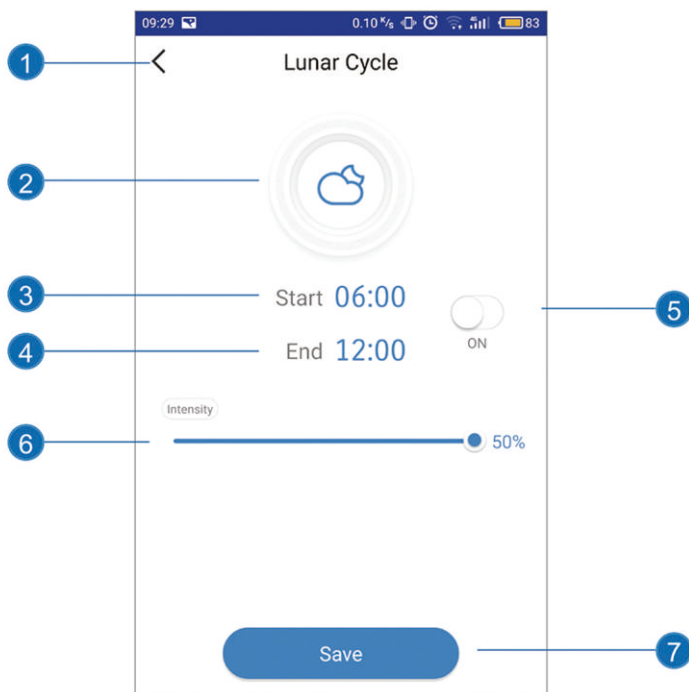

### 1 Lunar Cycle

Lunar Cycle decrease / increase intensity settings and stimulates moonset/moonrise and moonlights

### 2 Lunar Cycle Icon

Lunar cycle icon.

### 3 Lunar Cycle start time

Tap to set Dawn time.

### 4 Lunar Cycle end time

Tap to set Dusk time.

### 5 On/Off Button

Turn on/Off the Lunar Cycle.

### 6 Intensity Percentage

Slide the bar, percentage will change between 0%-100%.

### 7 Save Button

Tap to save current settings.



## Program Page



### 1 Select Button

Delete customized programs.

### 2 Standard Program

Factory program, can't be edited, no need to save. This is for people those who don't want to program or have lost user settings.

### 3 LPS

Factory recommend program for LPS Reef tank.

### 4 SPS

Factory recommend program for SPS Reef tank.

### 5 DIY

Do it yourself program. Added when you press "Add" button.

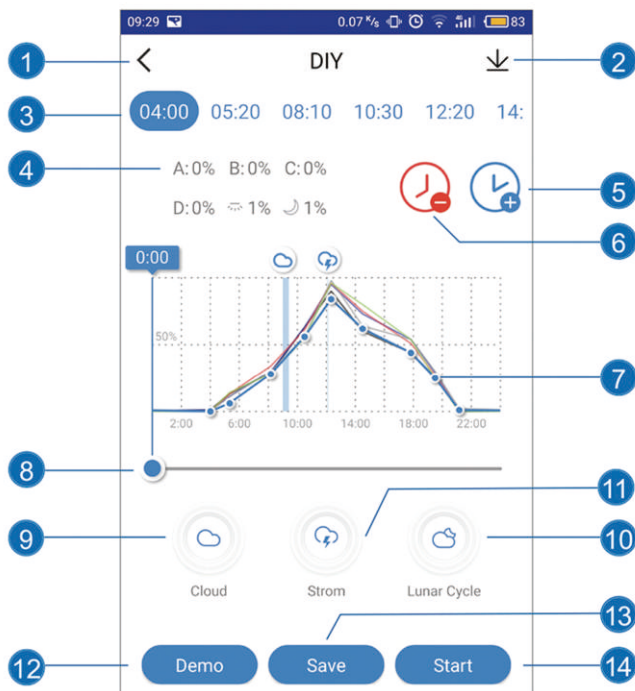

### 1 Back Button

Go back to previous page.

### 2 Download

Download program from the light.

### 3 Program Point

Tap to select point, tap again to edit point page.

### 4 Intensity Grade

Intensity grade of each color channel.

### 5 ADD

Tap to add a new time point.

### 6 Delete

Tap to delete the selected time point.

### 7 Intensity Curve

Autogeneration Intensity curve of each color channel.

### 8 Program Point Slide Bar

Slide to select time point.

### 9 Cloud

Tap to add Cloud effect.

### 11 Strom

Tap to add strom effect.

### 13 Save

Tap to save your DIY program.

### 10 Lunar Cycle

Tap to add Lunar Cycle effect.

### 12 Demo

Tap to preview the program on the light. It takes 30 seconds to run the program cycle once. It does not show Effect points.

### 14 Start

Tap to start running current DIY program.

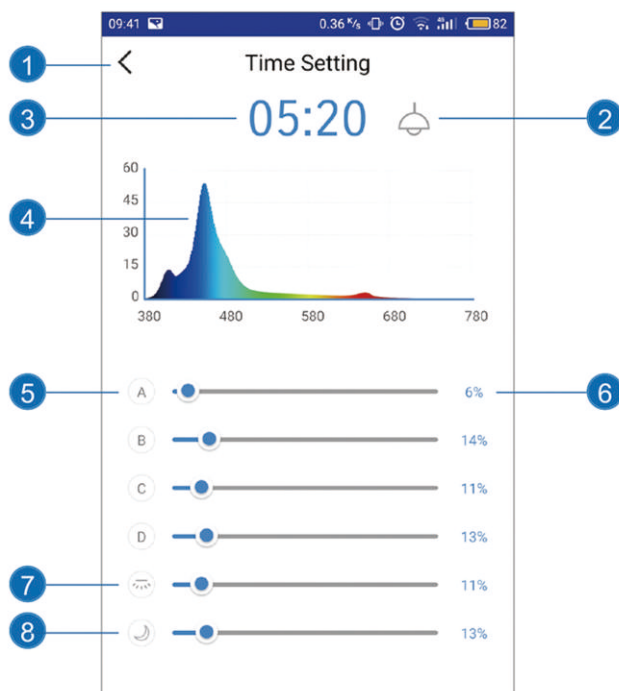

### 1 **Back Button**

Go back to previous page.

### 3 **Visual Switch**

Turn on the switch, can see brightness changing of the light when slide the color bar.

### 5 **Color Bar**

Slide the bar to change intensity of each color.

### 7 **Fill Light**

Slide the bar to change intensity of Fill light.

### 2 **Time**

Tap to set time.

### 4 **Spectrogram**

Current spectrogram of the light.

### 6 **Intensity Percentage**

Slide the bar, percentage will change between 0%-100%.

### 8 **Moon Light**

Slide the bar to change intensity of Angel Eyes moon light.

# Troubleshooting

- **Lose lamp(s) after setting up WiFi.**

Pull down the list to refresh.

Make sure light WiFi Indicator light is solid blue.

Make sure the phone is connected to the correct light WiFi SSID/Wireless router. If still not working, repeat Wi-Fi set up.

- **Can't find light WiFi name on your mobile device signal list.**

Make sure light didn't connect to household WiFi router.

Make sure mobile phone not too far away from light.

- **App crashes during connection.**

Make sure you connect to the right network.

Pull down the list to refresh.

- **One or more lamp(s) is missing.**

Make sure you connect to the correct light WiFi SSID/Wireless router. Pull down the list to refresh.

Make sure your mobile phone device not too far away from the light.

- **How to sync multiple lamps?**

Choose "connect WiFi router", search all lights near your household/store WiFi router. Select group lights you want to control at the same time.

- **Electric Power shut down.**

Make sure light is connected to the AC outlet.

Make sure you connect to the correct light WiFi SSID/Wireless router, then pull down the list to refresh.

- **The App and the lamp(s) is not synchronizing under Program Mode.**

Make sure your phone is at real time setting.

Make sure mobile phone connect to the correct light WiFi SSID/Wireless router, then pull down the list to refresh Enter Program Mode and make sure your customized program is "saved" and "started".

# Warranty

## ● Dear User:

In order to let you familiarly use our product and enjoy excellent after-sale service. Please read carefully the product instruction and installation diagram, and keep properly this card.

## ● Product Warranty:

This warranty card is the only proof for warranty, which should be stamped with distributor's seal. Customer enjoys 12-month warranty since the purchase of product (subject to the purchase date on sales receipt).

## ● Limited Warranty:

Cannot provide the certificate or valid sales document, or it is altered, or does not match the product.

Damaged by misuse, abnormal use, taking apart by yourself, altering the appearance and other human factors.

Damaged as a result of mistaken assembling, using and maintaining due to failure to follow instruction and diagram.

Normal wear and tear of consumable parts.

Break downed or damaged by natural disaster or other force majeure, such as earthquake, fire, typhoon, thunder and so on.

We are disclaimed responsibility for relevant equipment, tank creatures or furniture from other company. The service covered by the warranty is free. We will charge the service when the warranty card passes its last effective date or the service is not covered by warranty. The warranty card and sales receipt should be provide for repairing. Please keep it properly! Thanks!

Product Model number	
Item Serial Number	
Customer	
Address	
Dealer	
Purchase Date	



Please Scan the qr code to download the APP.



IOS



Android

